

Clarice Cliff - Printing

Lostwithiel Primary School

Year 4/5 Maple Class

Overarching Theme - Antiquity and Collectables

Art Knowledge Organiser

Prior Learning: Children will have previously developed a wide range of art and design techniques in using colour, pattern, texture, line, shape, form and space. Children will have previously explored landscape drawing with a focus on foreground and background.

Key Art knowledge and skills:

Clarice Cliff Background and Influences

- Clarice was born in January 20th 1899 Clarice Cliff born in Tunstall, Stoke-on-Trent, Staffs.
- Clarice started work as a gilder at the age of 13 and then progress to freehand pottery painting. Alongside this, she studied art and sculpture at night school.
- After a few years, Clarice moved to a new factory where she learnt skills such as enamelling and outlining. Her work was noticed by the factory owner who helped her to study at the Royal College of Art in Paris.
- Clarice went on to study at the Royal College of Art in Kensington. By 1929, she had a team of approximately 70 people working with her. She began to sell her work, be inspired by shapes, around the world.
- Famous work includes the 'Crocus Pattern' and 'Bizarre'.



Clarice Cliff Technique

- Children will design a landscape image of the local area that is inspired the use of 2D shapes building on prior learning of using line, shape, colour, space and form.
- Children will complete a simple line drawing and then appraise each other's work to make improvements for a final version filling this with bold colours and outlining to enhance shapes.
- Children will trace their design and place this over a polystyrene tile. A sharp pencil can then be used to trace over the lines, imprinting the design onto the tile.
- Using ink, plastic and a roller, children will cover their design evenly in ink, remove any excess and then press this firmly onto paper to create a printed image.
- Children can experiment with removing the 'background' of the tile and printing over with a second colour for effect.

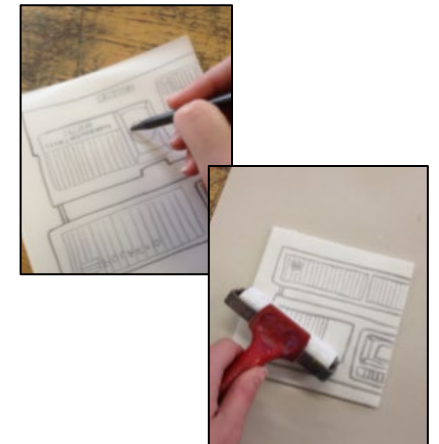

Key Art Vocabulary -		General Terms and Cross Curricular Vocabulary	
Printing	Transfer a design or pattern to a surface	Appraise	Assess the value or quality of
Outlining	Draw, trace, or define the outer edge or shape of	Freehand	Done without the use of anything to guide the hand
Contrast	The state of being strikingly different from something else	Pattern	A repeated decorative design
Smooth	Having an even or regular surface	Geographical Features	Naturally created features of earth
Imprinting	Impress or stamp (a mark or outline) on a surface	Mountain	A large natural elevation of the earth's surface rising abruptly from the surrounding level

Art Outcome	Cross Curricular Links
<ul style="list-style-type: none">• Children will produce a <i>Clarice Cliff</i> style line drawing based on observations from the local surroundings and images from around the world.• Children will use polystyrene tiles to print their design.	Geography - Children will take inspiration from <i>Geographical</i> learning about mountains and the environment.
Linked documents: <i>Class Overview</i> , <i>Art Whole School Progression</i> document and <i>Class Medium Term Planning</i> .	